

## 5. REPORT

### Background

5.1 An application for a new Premises Licence, by Bar Esteban Limited in respect of Bar Esteban under the Licensing Act 2003.

### 5.2 Details of the application being sought under the Premises Licence—APP 1

#### The Provision of Regulated Entertainment: Live Music and Recorded Music

|                     |              |
|---------------------|--------------|
| Monday to Thursday: | 1000 to 0000 |
| Friday to Saturday: | 1000 to 0030 |
| Sunday:             | 1000 to 2330 |

#### Late Night Refreshment

|                     |              |
|---------------------|--------------|
| Monday to Thursday: | 1000 to 0000 |
| Friday to Sunday:   | 1000 to 0030 |

#### Supply of Alcohol

|                     |              |
|---------------------|--------------|
| Monday to Thursday: | 1000 to 0000 |
| Friday to Saturday: | 1000 to 0030 |
| Sunday:             | 1000 to 2330 |

For consumption **ON** the premises

#### Hours open to the public

|                    |              |
|--------------------|--------------|
| Monday to Thursday | 0800 to 0000 |
| Friday to Sunday:  | 0800 to 0030 |

**New Years Eve the timing requested is from the start of permitted hours on 31st December until the start of the permitted hours on 1 January, Christmas Day and Good Friday 1200 to 0000.**

### General-all four licensing objectives

All endeavours will be made to meet all four Licensing objectives and to comply with the directions and recommendations of all the relevant bodies.

### 5.3 Crime and Disorder

This is a restaurant premises which has been licensed for almost 20 years without any incident, breach or disorder and will continue to operate as a family orientated restaurant providing good value and high end cuisine.

#### **5.4 Public Safety**

All Fire and Safety regulations will be complied with and all recommendations or directions given by all the appropriate local authority fire and environmental departments will be observed and implemented. As well as any other directions, guidelines or recommendations from any other relevant body upon whom notice of this application has been served.

#### **5.5 Public Nuisance**

This will be a high end restaurant catering for families and discerning diners and has operated as such for many years without complaint as to nuisance or crime. All efforts will be made to ensure that the restaurant is run in a professional manner without offence nuisance or interruption to any neighbour or general public. All recommendations and guidelines and regulations from all the relevant bodies will be complied with and implemented.

#### **5.6 Child Protection**

All the required safety regulations by way of fire and otherwise will be implemented and the premises will be equipped to seat children of all ages safely. All environmental regulations and recommendations by all relevant bodies will be complied with to ensure the safety of children dining. The interest of children will be paramount.

If in doubt of a child's age as far as it relates to the consumption of alcohol on the premises identification will be requested by way of driving licence or other appropriate identification and all staff will be trained to carry this out.

### **6. RELEVANT REPRESENTATIONS (CONSULTATION)**

#### **Responsible authorities:**

#### **6.1 Comments of Metropolitan Police**

Made representation regarding this application, but have now withdrawn their representation as they are satisfied with the control measures proposed to be implemented in relation to the Prevention of Crime and Disorder **Appendix 2**

#### **6.2 Comments of Regulatory Services:**

##### **Environmental Health**

Made representation regarding this application, but have now withdrawn their representation as they are satisfied with the control measures proposed to be implemented in relation to the Prevention of Public Nuisance. **Appendix 3**

## **Trading Standards**

Made representation regarding this application, but have now withdrawn their representation as they are satisfied with the control measures proposed to be implemented in relation to the Protection of Children from Harm **Appendix 4**

### **6.3 London Fire and Civil Defence Authority**

Have made no representation to this application

### **6.4 Planning Services**

Have made no representation to this application

### **6.5 Comments of Child Protection Agency or Nominee**

No representation made on this matter

### **7.0 Interested Parties – Appendix 5**

Representation has been received against this application. The applicants and their representative have written to the resident to answer the concerns that have been raised, copies of their letters are attached at Appendix 5A.

### **8.0 Financial Comments**

The fee which would be applicable for this application was **£190.00**.

## APPENDIX 1 – APPLICATION



HG1043 131  
 WK/237580  
 LN/000010595



**Haringey Council**

**Application for a premises licence to be granted under the Licensing Act 2003**

**PLEASE READ THE FOLLOWING INSTRUCTIONS FIRST**

Before completing this form please read the guidance notes at the end of the form. If you are completing this form by hand please write legibly in block capitals. In all cases ensure that your answers are inside the boxes and written in black ink. Use additional sheets if necessary.

You may wish to keep a copy of the completed form for your records.

I Stephen Lironi Director of Esteban Ltd (The Applicant)

*(Insert name(s) of applicant)*

apply for a premises licence under section 17 of the Licensing Act 2003 for the premises described in Part 1 below (the premises) and I/we are making this application to you as the relevant licensing authority in accordance with section 12 of the Licensing Act 2003

**Part 1 – Premises Details**

|   |        |                  |        |
|---|--------|------------------|--------|
| <b>Postal address of premises or, if none, ordnance survey map reference or description</b> |        |                  |        |
| Bar Esteban<br>Ground Floor<br>29 Park Road   |        |                  |        |
| <b>Post town</b>  | London | <b>Post code</b> | N8 8TE |

|   |         |
|---|---------|
| Telephone number at premises (if any)   |         |
| Non-domestic rateable value of premises | £28,250 |

**Part 2 - Applicant Details**

Please state whether you are applying for a premises licence as  
 Please tick yes

- a) an individual or individuals \*  please complete section (A)
- b) a person other than an individual \*
  - i. as a limited company  please complete section (B)
  - ii. as a partnership  please complete section (B)
  - iii. as an unincorporated association or  please complete section (B)

- iv. other (for example a statutory corporation)  please complete section (B)
- c) a recognised club  please complete section (B)
- d) a charity  please complete section (B)
- e) the proprietor of an educational establishment  please complete section (B)
- f) a health service body  please complete section (B)
- g) a person who is registered under Part 2 of the Care Standards Act 2000 (c14) in respect of an independent hospital in Wales  please complete section (B)
- ga) a person who is registered under Chapter 2 of Part 1 of the Health and Social Care Act 2008 (within the meaning of that Part) in an independent hospital in England  please complete section (B)
- h) the chief officer of police of a police force in England and Wales  please complete section (B)

\* If you are applying as a person described in (a) or (b) please confirm:

Please tick yes

- I am carrying on or proposing to carry on a business which involves the use of the premises for licensable activities; or
- I am making the application pursuant to a
  - statutory function or
  - a function discharged by virtue of Her Majesty's prerogative

**(A) INDIVIDUAL APPLICANTS** (fill in as applicable)

|   |                              |                               |                             |                                |                 |
|---|------------------------------|-------------------------------|-----------------------------|--------------------------------|-----------------|
| Mr <input type="checkbox"/>                               | Mrs <input type="checkbox"/> | Miss <input type="checkbox"/> | Ms <input type="checkbox"/> | Other Title (for example, Rev) |                 |
| Surname   |                              |                               | First names                 |                                |                 |
| I am 18 years old or over                                 |                              |                               |                             | <input type="checkbox"/>       | Please tick yes |
| Current postal address if different from premises address |                              |                               |                             |                                |                 |
| Post Town   |                              |                               |                             | Postcode                       |                 |
| Daytime contact telephone number                          |                              |                               |                             |                                |                 |
| E-mail address (optional)                                 |                              |                               |                             |                                |                 |

**SECOND INDIVIDUAL APPLICANT (if applicable)**

|   |                              |                               |                             |                                |  |
|---|------------------------------|-------------------------------|-----------------------------|--------------------------------|--|
| Mr <input type="checkbox"/>                               | Mrs <input type="checkbox"/> | Miss <input type="checkbox"/> | Ms <input type="checkbox"/> | Other Title (for example, Rev) |  |
| Surname   |                              |                               | First names                 |                                |  |
| I am 18 years old or over                                 |                              |                               |                             |                                | <input type="checkbox"/> Please tick yes |
| Current postal address if different from premises address |                              |                               |                             |                                |  |
| Post Town   |                              |                               |                             | Postcode                       |  |
| Daytime contact telephone number                          |                              |                               |                             |                                |  |
| E-mail address (optional)                                 |                              |                               |                             |                                |  |

**(B) OTHER APPLICANTS**

Please provide name and registered address of applicant in full. Where appropriate please give any registered number. In the case of a partnership or other joint venture (other than a body corporate), please give the name and address of each party concerned.

|  |
|--|
| Name<br>Bar Esteban Limited  |
| Address<br><br>7 St Johns Road<br>Harrow<br>Middlesex<br>HA1   |
| Registered number (where applicable)<br>8206610  |
| Description of applicant (for example, partnership, company, unincorporated association etc.)<br><br>Company |
| Telephone number (if any)<br>07767761160 (Stephen Lironi Director)   |
| E-mail address (optional)  |

### Part 3 Operating Schedule

When do you want the premises licence to start?

| Day |   | Month |   | Year |   |   |   |
|-----|---|-------|---|------|---|---|---|
| 0   | 5 | 0     | 1 | 2    | 0 | 1 | 3 |

If you wish the licence to be valid only for a limited period, when do you want it to end?

| Day |  | Month |  | Year |  |  |  |
|-----|--|-------|--|------|--|--|--|
|     |  |       |  |      |  |  |  |

Please give a general description of the premises (please read guidance note1)

The premises is a restaurant and has traded as such for almost 20 years without any problems. The reason for the application is that the previous tenant company had gone into liquidation in July of 2011 and the current intended purchaser or freeholder was not aware of this and the License had inadvertently lapsed.

What consideration have you given to the immediate locality with regards to the licensable activities you are applying for?

This is an existing licensed premises as described above. The intended nature of the venture will be that of an up market Spanish restaurant providing high quality Spanish Tapas as well as a very carefully chosen wine list representing different regions of Spain.



If 5,000 or more people are expected to attend the premises at any one time, please state the number expected to attend.

What licensable activities do you intend to carry on from the premises?

(Please see sections 1 and 14 of the Licensing Act 2003 and Schedules 1 and 2 to the Licensing Act 2003)

**Provision of regulated entertainment**

**Please tick yes**

- |   |                                     |
|---|-------------------------------------|
| a) plays (if ticking yes, fill in box A)  | <input type="checkbox"/>            |
| b) films (if ticking yes, fill in box B)  | <input type="checkbox"/>            |
| c) indoor sporting events (if ticking yes, fill in box C)   | <input type="checkbox"/>            |
| d) boxing or wrestling entertainment (if ticking yes, fill in box D)  | <input type="checkbox"/>            |
| e) live music (if ticking yes, fill in box E)   | <input checked="" type="checkbox"/> |
| f) recorded music (if ticking yes, fill in box F)   | <input checked="" type="checkbox"/> |
| g) performances of dance (if ticking yes, fill in box G)  | <input type="checkbox"/>            |
| h) anything of a similar description to that falling within (e), (f) or (g) (if ticking yes, fill in box H) | <input type="checkbox"/>            |

**Provision of entertainment facilities:**

- |   |                          |
|---|--------------------------|
| i) making music (if ticking yes, fill in box I)   | <input type="checkbox"/> |
| j) dancing (if ticking yes, fill in box J)  | <input type="checkbox"/> |
| k) entertainment of a similar description to that falling within (i) or (j) (if ticking yes, fill in box K) | <input type="checkbox"/> |

**Provision of late night refreshment** (if ticking yes, fill in box L)

**Supply of alcohol** (if ticking yes, fill in box M)

In all cases complete boxes N, O and P

**A**

| Plays<br>Standard days and timings (please read guidance note 6) |       |        | <u>Will the performance of a play take place indoors or outdoors or both – please tick</u><br>(please read guidance note 2)  | Indoors  | <input type="checkbox"/> |
|--|-------|--------|--|----------|--------------------------|
| Day  | Start | Finish |  | Outdoors | <input type="checkbox"/> |
| Mon  |       |        | <u>Please give further details here</u> (please read guidance note 3)  | Both     | <input type="checkbox"/> |
| Tue  |       |        |  |          |                          |
| Wed  |       |        | <u>State any seasonal variations for performing plays</u> (please read guidance note 4)  |          |                          |
| Thur   |       |        |  |          |                          |
| Fri  |       |        | <u>Non standard timings. Where you intend to use the premises for the performance of plays at different times to those listed in the column on the left, please list</u> (please read guidance note 5) |          |                          |
| Sat  |       |        |  |          |                          |
| Sun  |       |        |  |          |                          |

**B**

|   |              |               |  |          |                          |
|---|--------------|---------------|--|----------|--------------------------|
| <b>Films</b><br>Standard days and timings (please read guidance note 6) |              |               | <b><u>Will the exhibition of films take place indoors or outdoors or both – please tick</u></b> (please read guidance note 2)  | Indoors  | <input type="checkbox"/> |
|   |              |               |  | Outdoors | <input type="checkbox"/> |
|   |              |               |  | Both     | <input type="checkbox"/> |
| <b>Day</b>  | <b>Start</b> | <b>Finish</b> | <b><u>Please give further details here</u></b> (please read guidance note 3)   |          |                          |
| Mon   |              |               |  |          |                          |
| Tue   |              |               | <b><u>State any seasonal variations for the exhibition of films</u></b> (please read guidance note 4)  |          |                          |
| Wed   |              |               |  |          |                          |
| Thur  |              |               | <b><u>Non standard timings. Where you intend to use the premises for the exhibition of films at different times to those listed in the column on the left, please list</u></b> (please read guidance note 5) |          |                          |
| Fri   |              |               |  |          |                          |
| Sat   |              |               |  |          |                          |
| Sun   |              |               |  |          |                          |

**C**

|  |       |        |   |
|--|-------|--------|---|
| <b>Indoor sporting events</b><br>Standard days and timings (please read guidance note 6) |       |        | <b><u>Please give further details</u></b> (please read guidance note 3)   |
| Day  | Start | Finish |   |
| Mon  |       |        |   |
|  |       |        |   |
| Tue  |       |        | <b><u>State any seasonal variations for indoor sporting events</u></b> (please read guidance note 4)  |
|  |       |        |   |
| Wed  |       |        |   |
|  |       |        |   |
| Thur   |       |        | <b><u>Non standard timings. Where you intend to use the premises for indoor sporting events at different times to those listed in the column on the left, please list</u></b> (please read guidance note 5) |
|  |       |        |   |
| Fri  |       |        |   |
|  |       |        |   |
| Sat  |       |        |   |
|  |       |        |   |
| Sun  |       |        |   |
|  |       |        |   |

**D**

|  |       |        |  |          |                          |
|--|-------|--------|--|----------|--------------------------|
| <b>Boxing or wrestling entertainments</b><br>Standard days and timings (please read guidance note 6) |       |        | <b><u>Will the boxing or wrestling entertainment take place indoors or outdoors or both – please tick</u></b> (please read guidance note 2)  | Indoors  | <input type="checkbox"/> |
|  |       |        |  | Outdoors | <input type="checkbox"/> |
|  |       |        |  | Both     | <input type="checkbox"/> |
| Day  | Start | Finish | <b><u>Please give further details here</u></b> (please read guidance note 3)   |          |                          |
| Mon  | 1     |        |  |          |                          |
| Tue  |       |        | <b><u>State any seasonal variations for boxing or wrestling entertainment</u></b> (please read guidance note 4)  |          |                          |
| Wed  |       |        |  |          |                          |
| Thur   |       |        | <b><u>Non standard timings. Where you intend to use the premises for boxing or wrestling entertainment at different times to those listed in the column on the left, please list</u></b> (please read guidance note 5) |          |                          |
| Fri  |       |        |  |          |                          |
| Sat  |       |        |  |          |                          |
| Sun  |       |        |  |          |                          |

**E**

| Live music<br>Standard days and<br>timings (please read<br>guidance note 6) |       |        | <u>Will the performance of live music take place<br/>indoors or outdoors or both – please tick</u><br>(please read guidance note 2)   | Indoors  | <input checked="" type="checkbox"/> |
|---|-------|--------|---|----------|-------------------------------------|
| Day   | Start | Finish |   | Outdoors | <input type="checkbox"/>            |
|   |       |        |   | Both     | <input type="checkbox"/>            |
| Mon   | 10.00 | 0000   | <b><u>Please give further details here</u></b> (please read guidance note 3)<br><br>The music will be more background music and will be at a level so that diners are not disturbed and can converse comfortably  |          |                                     |
| Tue   | 10.00 | 0000   |   |          |                                     |
| Wed   | 10.00 | 0000   | <b><u>State any seasonal variations for the performance of live music</u></b><br>(please read guidance note 4)<br><br>New Years Eve the timing requested is from the start of permitted hours on 31 December until the start of permitted hours on 1 January Christmas Day and Good Friday 1200 to 0000 |          |                                     |
| Thur  | 10.00 | 0000   |   |          |                                     |
| Fri   | 10.00 | 0030   | <b><u>Non standard timings. Where you intend to use the premises for the performance of live music at different times to those listed in the column on the left, please list</u></b> (please read guidance note 5)  |          |                                     |
| Sat   | 10.00 | 0030   |   |          |                                     |
| Sun   | 10.00 | 2330   |   |          |                                     |

**F**

| Recorded music<br>Standard days and timings (please read guidance note 6) |       |        | Will the playing of recorded music take place indoors or outdoors or both – please tick (please read guidance note 2)   | Indoors  | <input checked="" type="checkbox"/> |
|---|-------|--------|---|----------|-------------------------------------|
|   |       |        |   | Outdoors | <input type="checkbox"/>            |
|   |       |        |   | Both     | <input type="checkbox"/>            |
| Day   | Start | Finish |   |          |                                     |
| Mon   | 10.00 | 0000   | <p><b>Please give further details here</b> (please read guidance note 3)</p> <p>The music will be background music so that restaurant diners are not disturbed and can converse normally without interruption.</p> <p>The music will remain at a level that is not above normal conversation.</p>   |          |                                     |
| Tue   | 10.00 | 0000   |   |          |                                     |
| Wed   | 10.00 | 0000   | <p><b>State any seasonal variations for the playing of recorded music</b> (please read guidance note 4)</p>   |          |                                     |
| Thur  | 10.00 | 0000   |   |          |                                     |
| Fri   | 10.00 | 0030   | <p><b>Non standard timings. Where you intend to use the premises for the playing of recorded music at different times to those listed in the column on the left, please list</b> (please read guidance note 5)</p> <p>New Years Eve from the start of permitted hours on 31 December until start of permitted hours on 1 January. Christmas Day and Good Friday 1200 to 0000.</p> |          |                                     |
| Sat   | 10.00 | 0030   |   |          |                                     |
| Sun   | 10.00 | 2330   |   |          |                                     |



**G**

|   |       |        |   |          |                          |
|---|-------|--------|---|----------|--------------------------|
| <b>Performances of dance</b><br>Standard days and timings (please read guidance note 6) |       |        | <b><u>Will the performance of dance take place indoors or outdoors or both – please tick</u></b><br>(please read guidance note 2)   | Indoors  | <input type="checkbox"/> |
|   |       |        |   | Outdoors | <input type="checkbox"/> |
|   |       |        |   | Both     | <input type="checkbox"/> |
| Day   | Start | Finish | <b><u>Please give further details here</u></b> (please read guidance note 3)  |          |                          |
| Mon   |       |        |   |          |                          |
| Tue   |       |        | <b><u>State any seasonal variations for the performance of dance</u></b><br>(please read guidance note 4)   |          |                          |
| Wed   |       |        |   |          |                          |
| Thur  |       |        | <b><u>Non standard timings. Where you intend to use the premises for the performance of dance at different times to those listed in the column on the left, please list</u></b> (please read guidance note 5) |          |                          |
| Fri   |       |        |   |          |                          |
| Sat   |       |        |   |          |                          |
| Sun   |       |        |   |          |                          |

# H

|  |       |        |  |          |                          |
|--|-------|--------|--|----------|--------------------------|
| <b>Anything of a similar description to that falling within (e), (f) or (g)</b><br>Standard days and timings (please read guidance note 6) |       |        | <b><u>Please give a description of the type of entertainment you will be providing</u></b>   |          |                          |
| Day  | Start | Finish | <b><u>Will this entertainment take place indoors or outdoors or both – please tick</u></b> (please read guidance note 2)   | Indoors  | <input type="checkbox"/> |
| Mon  |       |        |  | Outdoors | <input type="checkbox"/> |
|  |       |        |  | Both     | <input type="checkbox"/> |
| Tue  |       |        | <b><u>Please give further details here</u></b> (please read guidance note 3)   |          |                          |
| Wed  |       |        |  |          |                          |
| Thur   |       |        | <b><u>State any seasonal variations for entertainment of a similar description to that falling within (e), (f) or (g)</u></b> (please read guidance note 4)  |          |                          |
| Fri  |       |        |  |          |                          |
| Sat  |       |        | <b><u>Non standard timings. Where you intend to use the premises for the entertainment of a similar description to that falling within (e), (f) or (g) at different times to those listed in the column on the left, please list</u></b> (please read guidance note 5) |          |                          |
| Sun  |       |        |  |          |                          |

I

|  |       |        |   |                          |
|--|-------|--------|---|--------------------------|
| <b>Provision of facilities for making music</b><br>Standard days and timings (please read guidance note 6) |       |        | <b><u>Please give a description of the facilities for making music you will be providing</u></b>  |                          |
|  |       |        | <b><u>Will the facilities for making music be indoors or outdoors or both – please tick</u></b><br>(please read guidance note 2)  |                          |
| Day  | Start | Finish | Indoors   | <input type="checkbox"/> |
|  |       |        | Outdoors  | <input type="checkbox"/> |
|  |       |        | Both  | <input type="checkbox"/> |
| Mon  |       |        | <b><u>Please give further details here</u></b> (please read guidance note 3)  |                          |
|  |       |        |   |                          |
| Tue  |       |        | <b><u>State any seasonal variations for the provision of facilities for making music</u></b> (please read guidance note 4)  |                          |
|  |       |        |   |                          |
| Wed  |       |        | <b><u>Non standard timings. Where you intend to use the premises for provision of facilities for making music at different times to those listed in the column on the left, please list</u></b> (please read guidance note 5) |                          |
|  |       |        |   |                          |
| Thur   |       |        |   |                          |
|  |       |        |   |                          |
| Fri  |       |        |   |                          |
|  |       |        |   |                          |
| Sat  |       |        |   |                          |
|  |       |        |   |                          |
| Sun  |       |        |   |                          |
|  |       |        |   |                          |

**J**

|   |       |        |   |          |                          |
|---|-------|--------|---|----------|--------------------------|
| <b>Provision of facilities for dancing</b><br>Standard days and timings (please read guidance note 6) |       |        | <b>Will the facilities for dancing be indoors or outdoors or both – please tick</b> (see guidance note 2)   | Indoors  | <input type="checkbox"/> |
|   |       |        |   | Outdoors | <input type="checkbox"/> |
|   |       |        |   | Both     | <input type="checkbox"/> |
|   |       |        | <b>Please give a description of the facilities for dancing you will be providing</b>  |          |                          |
| Day   | Start | Finish |   |          |                          |
| Mon   |       |        | <b>Please give further details here</b> (please read guidance note 3)   |          |                          |
| Tue   |       |        |   |          |                          |
| Wed   |       |        | <b>State any seasonal variations for providing dancing facilities</b> (please read guidance note 4)   |          |                          |
| Thur  |       |        |   |          |                          |
| Fri   |       |        | <b>Non standard timings. Where you intend to use the premises for the provision of facilities for dancing entertainment at different times to those listed in the column on the left, please list</b> (please read guidance note 5) |          |                          |
| Sat   |       |        |   |          |                          |
| Sun   |       |        |   |          |                          |

**K**

|  |       |        |  |          |                          |
|--|-------|--------|--|----------|--------------------------|
| <b>Provision of facilities for entertainment of a similar description to that falling within i or j</b><br>Standard days and timings (please read guidance note 6) |       |        | <u>Please give a description of the type of entertainment facility you will be providing</u>   |          |                          |
| Day  | Start | Finish | <b>Will the entertainment facility be indoors or outdoors or both – please tick</b> (please read guidance note 2)  | Indoors  | <input type="checkbox"/> |
| Mon  |       |        |  | Outdoors | <input type="checkbox"/> |
|  |       |        |  | Both     | <input type="checkbox"/> |
| Tue  |       |        | <u>Please give further details here</u> (please read guidance note 3)  |          |                          |
| Wed  |       |        |  |          |                          |
| Thur   |       |        | <u>State any seasonal variations for the provision of facilities for entertainment of a similar description to that falling within i or j</u><br>(please read guidance note 4)   |          |                          |
| Fri  |       |        |  |          |                          |
| Sat  |       |        | <u>Non standard timings. Where you intend to use the premises for the provision of facilities for entertainment of a similar description to that falling within i or j at different times to those listed in the column on the left, please list</u> (please read guidance note 5) |          |                          |
| Sun  |       |        |  |          |                          |

L

| Late night refreshment<br>Standard days and<br>timings (please read<br>guidance note 6) |       |        | Will the provision of late night refreshment<br>take place indoors or outdoors or both –<br>please tick (please read guidance note 2)   | Indoors  | <input checked="" type="checkbox"/> |
|---|-------|--------|---|----------|-------------------------------------|
|   |       |        |   | Outdoors | <input type="checkbox"/>            |
|   |       |        |   | Both     | <input type="checkbox"/>            |
| Day   | Start | Finish |   |          |                                     |
| Mon   | 10.00 | 0000   | <b>Please give further details here</b> (please read guidance note 3)<br><br>The premises will operate as a high end restaurant   |          |                                     |
|   |       |        |   |          |                                     |
| Tue   | 10.00 | 0000   | <b>State any seasonal variations for the provision of late night<br/>refreshment</b> (please read guidance note 4)  |          |                                     |
|   |       |        |   |          |                                     |
| Wed   | 10.00 | 0000   |   |          |                                     |
|   |       |        |   |          |                                     |
| Thur  | 10.00 | 0000   |   |          |                                     |
|   |       |        |   |          |                                     |
| Fri   | 10.00 | 0030   | <b>Non standard timings. Where you intend to use the premises<br/>for the provision of late night refreshment at different times, to<br/>those listed in the column on the left, please list</b> (please read<br>guidance note 5) |          |                                     |
|   |       |        |   |          |                                     |
| Sat   | 10.00 | 0030   | New Years Eve from the start of permitted hours on 31 December<br>until start of permitted hours on 1 January. Christmas Day and<br>Good Friday 1200 to 0000  |          |                                     |
|   |       |        |   |          |                                     |
| Sun   | 10.00 | 0030   |   |          |                                     |
|   |       |        |   |          |                                     |

**M**

|   |       |        |   |                  |                                     |
|---|-------|--------|---|------------------|-------------------------------------|
| <b>Supply of alcohol</b><br>Standard days and timings (please read guidance note 6) |       |        | <b>Will the supply of alcohol be for consumption (Please tick box)</b> (please read guidance note 7)  | On the premises  | <input checked="" type="checkbox"/> |
|   |       |        |   | Off the premises | <input type="checkbox"/>            |
|   |       |        |   | Both             | <input type="checkbox"/>            |
| Day   | Start | Finish | <b>State any seasonal variations for the supply of alcohol</b> (please read guidance note 4)  |                  |                                     |
| Mon   | 10.00 | 0000   |   |                  |                                     |
| Tue   | 10.00 | 0000   |   |                  |                                     |
| Wed   | 10.00 | 0000   |   |                  |                                     |
| Thur  | 10.00 | 0000   |   |                  |                                     |
| Fri   | 10.00 | 0030   |   |                  |                                     |
| Sat   | 10.00 | 0030   |   |                  |                                     |
| Sun   | 10.00 | 2330   |   |                  |                                     |
|   |       |        | <b>Non standard timings. Where you intend to use the premises for the supply of alcohol at different times to those listed in the column on the left, please list</b> (please read guidance note 5) |                  |                                     |
|   |       |        | New Years Eve from the start of permitted hours on 31 December until start of permitted hours on 1 January. Christmas Day and Good Friday 1200 to 0000  |                  |                                     |

**State the name and details of the individual whom you wish to specify on the licence as premises supervisor**

|   |  |
|---|--|
| <b>Name</b><br>Stephen Lironi   |  |
| <b>Address</b><br><br>1 Hatherley Gardens<br>London<br>N8 9JH               |  |
| <b>Postcode</b>   |  |
| <b>Personal Licence number (if known)</b><br>LN000010407                    |  |
| <b>Issuing licensing authority (if known)</b><br>London Borough of Haringey |  |

**N**

Please highlight any adult entertainment or services, activities, other entertainment or matters ancillary to the use of the premises that may give rise to concern in respect of children (please read guidance note 8)

There will be none

**O**

| Hours premises are open to the public<br>Standard days and timings (please read guidance note 6) |       |        | <u>State any seasonal variations</u> (please read guidance note 4)  |
|--|-------|--------|---|
| Day  | Start | Finish |   |
| Mon  | 08.00 | 0000   | <p><b><u>Non standard timings. Where you intend the premises to be open to the public at different times from those listed in the column on the left, please list</u></b> (please read guidance note 5)</p> <p>New Years Eve from the start of permitted hours on 31 December until start of permitted hours on 1 January. Christmas Day and Good Friday 1200 to 0000</p> |
| Tue  | 08.00 | 0000   |   |
| Wed  | 08.00 | 0000   |   |
| Thur   | 08.00 | 0000   |   |
| Fri  | 08.00 | 0030   |   |
| Sat  | 08.00 | 0030   |   |
| Sun  | 08.00 | 0030   |   |
|  |       |        |   |



**P** Describe the steps you intend to take to promote the four licensing objectives:

**a) General – all four licensing objectives (b,c,d,e)** (please read guidance note 9)

All endeavors will we made to meet all 4 Licensing objectives and to comply with the directions and recommendations of all the relevant bodies.

**b) The prevention of crime and disorder**

This is a restaurant premises which has been licensed for almost 20 years without any incident or breach or disorder and will continue to operated as a family orientated restaurant providing good value and high end cuisine

**c) Public safety**

All Fire and Safety Regulations will be complied with and all recommendations or directions given by all the appropriate local authority fire and environmental departments will be observed and implemented as well as any other directions, guidelines or recommendations from any other relevant body upon whom notice of this application has been served.

**d) The prevention of public nuisance**

This will be a high end restaurant catering for families and discerning diners and has operated as such for many years without complain as to nuisance or crime. All efforts will be made to ensure that the restaurant is run in a professional manner without offence nuisance or interruption to any neighbour or general public and all recommendations and guidelines and regulations from all the relevant bodies will be complied with and implemented.

**e) The protection of children from harm**

All the required safety regulations by way of fire and otherwise will be implemented and the premises will be equipped to seat children of all ages safely and all environmental regulations and recommendations by all relevant bodies will be complied with to ensure the safety of the children diners. The interest of the children will be paramount. If in doubt of a child's age as far as it relates to the consumption of alcohol on the premises identification will be requested by way of driving licence or other appropriate identification and all staff will be trained to carry this out.

Please tick yes

- I have made or enclosed payment of the fee
- I have enclosed the plan of the premises
- I have sent copies of this application and the plan to responsible authorities and others where applicable
- I have enclosed the consent form completed by the individual I wish to be premises supervisor, if applicable
- I understand that I must now advertise my application
- I understand that if I do not comply with the above requirements my application will be rejected

**IT IS AN OFFENCE, LIABLE ON CONVICTION TO A FINE UP TO LEVEL 5 ON THE STANDARD SCALE, UNDER SECTION 158 OF THE LICENSING ACT 2003 TO MAKE A FALSE STATEMENT IN OR IN CONNECTION WITH THIS APPLICATION**

**Part 4 – Signatures** (please read guidance note 10)

**Signature of applicant or applicant’s solicitor or other duly authorised agent** (See guidance note 11). **If signing on behalf of the applicant please state in what capacity.**

|           |   |
|-----------|---|
| Signature |  |
| Date      | 27 November 2012  |
| Capacity  | Solicitor   |

**For joint applications signature of 2<sup>nd</sup> applicant or 2<sup>nd</sup> applicant’s solicitor or other authorised agent.** (please read guidance note 12). **If signing on behalf of the applicant please state in what capacity.**

|           |  |
|-----------|--|
| Signature |  |
| Date      |  |
| Capacity  |  |

|  |               |                  |        |
|--|---------------|------------------|--------|
| <b>Contact name (where not previously given) and postal address for correspondence associated with this application</b> (please read guidance note 13) |               |                  |        |
| Nick Demos<br>P George & Co Solicitors<br>42 Elder Avenue  |               |                  |        |
| <b>Post town</b>   | London        | <b>Post code</b> | N8 8PS |
| <b>Telephone number (if any)</b>   | 020 8341 9080 |                  |        |
| <b>If you would prefer us to correspond with you by e-mail your e-mail address (optional)</b><br>info@pgeorgesolicitors.co.uk                          |               |                  |        |



Haringey Council

## Consent of individual to being specified as premises supervisor

Reference number:

I [full name of prospective premises supervisor]

STEPHEN LIRONI

of [home address of prospective premises supervisor]

1 HATHERLEY GARDENS  
LONDON  
N8

hereby confirm that I give my consent to be specified as the designated premises supervisor in relation to the application for

[type of application]

NEW PREMISES LICENCE

by

[name of applicant]

ESTEBAN LIMITED

relating to a premises licence

[number of existing licence, if any]

N/A

for

[name and address of premises to which the application relates]

BAR ESTEBAN  
GROUND FLOOR  
29 PARK ROAD  
LONDON N8 8TE

and any premises licence to be granted or varied in respect of this application made by

[name of applicant]

N/A

CONTINUED

concerning the supply of alcohol at

[name and address of premises to which application relates]

BAR ESTEBAN  
29 PARK ROAD  
LONDON  
N8 8TE

I also confirm that I am applying for, intend to apply for or currently hold a personal licence, details of which I set out below.

Personal licence number LN 000070407

[insert personal licence number, if any]

Personal licence issuing authority

[insert name and address and telephone number of personal licence issuing authority, if any]

L.B HARINGEY  
THE LICENSING TEAM  
UNIT 271 LEE VALLEY TECHOPARK  
ASHLEY ROAD  
TOTTENHAM HALE  
LONDON N17 9LN

Signed



Name (please print)

STEPHEN LIRONI

Date

28/11/12

- KEY**
- FE = FIRE ESCAPE
  - S = SMOKE ALARM
  - FD = FIRE DOOR
  - FB = FIRE BLANKET
  - F = FIRE EXTINGUISHER

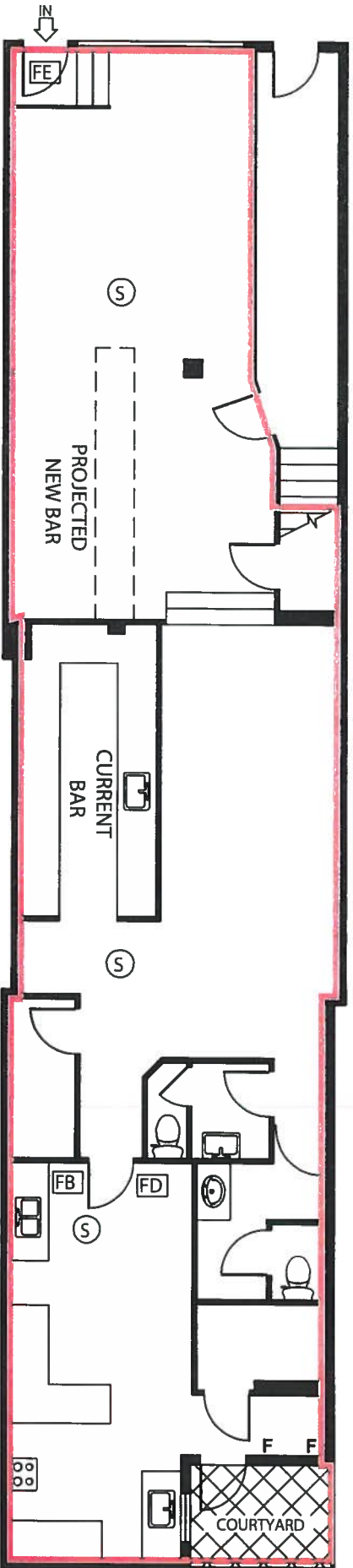

**DRAWING TITLE -**

29 PARK ROAD  
CROUCH END  
LONDON  
N8

**DATE-**

19 NOVEMBER 2012

**REVISION**

1 OF 1



**SCALE: 1:100 AT A4**

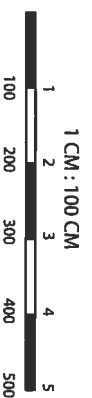

SCALE: For the plan to be scale, the above scale bar must measure correct when printed (for example 5cm)

**APPENDIX 2 – METROPOLITAN POLICE REPRESENTATION**



**POLICE REPRESENTATION**

**Name and address of premises:**

Bar Esteban, 29 Park Road N8 8TE

**Type of Application:** New Premises Licence.

**I wish to make representation on the following:**

- Prevention of crime and disorder

If this application were granted in full or part, I would recommend the following alterations be made to the licence conditions. I also suggest that additional conditions be attached to the licence, as set out below, to further promote the licensing objectives.

|   | <b>Current Conditions</b>      | <b>Recommendation</b>  |
|---|--------------------------------|--|
| 1 | CCTV System will be installed. | <p>A digital CCTV system to be installed in the premises.</p> <p>Cameras must be sited to observe the entrance doors from the inside.</p> <p>Cameras on the entrances must capture full frame shots of the heads and shoulders of all people entering the premises i.e. capable of identification.</p> <p>Provide a linked record of the date, time, and place of any image.</p> <p>Provide good quality images - colour during opening times.</p> |

|   |  |  |
|---|--|--|
| 2 |  | <p>Have a monitor to review images and recorded quality.</p> <p>Be regularly maintained to ensure continuous quality of image capture and retention.</p> <p>Staff trained in operating CCTV.</p> <p>Digital images must be kept for 31 days. The equipment must have a suitable export method, e.g. CD/DVD writer so that Police can make an evidential copy of the data they require. Copies must be available within a reasonable time to Police on request.</p> <p>Venue should close to the public 30 minutes after alcohol sales cease to allow a wind down time.</p> |
|---|--|--|

This is under the Protection of Children from Harm Objective.

Challenge 25 Policy Implemented:

I recommend that the following form of verification of a person's proof of age is:

- A valid passport.
- A photo driving licence
- A proof of age standard card system
- A citizen card, supported by the Home Office.

If these conditions were accepted in full I would withdraw my representation.

Officer: Mark Greaves  
Licensing Officer Haringey Police

Tel: 020 3276 0150

Mark.Greaves@Met.Police.UK

Date: 11th December 2012



**APPENDIX 3 – ENVIROMENTAL HEALTH- ENFORCEMENT RESPONSE  
REPRESENTATION**

**Shah Noshaba**

**From:** Nicolaou George (Enforcement)  
**Sent:** 30 November 2012 15:43  
**To:** Shah Noshaba, Licensing  
**Cc:** Pearce Derek  
**Subject:** WK/000237580  
**M3PPRef:** WK/000237580  
**M3PPUnique:** 00000004319E77AA8F6D211B04E00805FA682C2070091B275CEE796D011AFE900805FA682C200000096322C0000810D9B31C4A36243A85A2CF2809983E9000

**Licensing Consultation**

To: Licensing Officer

From: Enforcement Response Officer (Noise)

Name of Officer preparing representation: GEORGE NICOLAOU  
 cc: Team Leader Enforcement Response, Derek Pearce

Our Reference: WK/000237580

Date: 30th November 2012

Premises: Bar Esteban, Shop, 29 Park Road, Hornsey, London, N8 8TE

Type of application: New

I would like to confirm that I have considered the above proposal with regard to the prevention of public nuisance on behalf of the Enforcement Response (Noise) Team & would like to make representations to the Application

The operating schedule does not address the prevention of public nuisance from:

- airborne entertainment noise
- Structure borne noise or vibrations from entertainment
- Noise generated by patrons in external areas of the premises
- Noise generated from deliveries
- Noise generated from refuse collections
- Noise from plant and machinery
- Light nuisance
- Cooking odour

**Prevention of nuisance from noise / vibration**

All doors and windows will remain closed during the licensed regulated entertainment activities or in any event after 11pm. The entrance door will be fitted with a self-closing device and staff required to ensure that it is not propped open. A member of staff shall be made responsible to ensure the door is opened for as brief a period as possible. Where necessary adequate and suitable mechanical ventilation should be provided to public areas

The regulated entertainment licensable activity shall conclude 30 minutes before the premises is due to close to prevent excessive noise breakout as the premises empties

**Structure borne noise**

All speakers are mounted on anti-vibration mountings to prevent vibration transmission of sound energy to adjoining properties

**Sound limits**

The licensee shall ensure that no music played in the licensed premises is audible at or within the site boundary of any residential property

All regulated entertainment amplified activity will utilise the in-house amplification system, the maximum output of which is controlled by the duty manager

The level of amplified regulated entertainment shall be controlled by means of limiting device set at a level which upon request may be agreed with the licensing authority

**Outside Areas**

No music will be played in, or for the benefit of patrons in external areas of the premises premises

No form of loudspeaker or sound amplification equipment is to be sited on or near the exterior premises or in or near any foyer, doorway, window or opening to the premises

Signs shall be displayed in the external areas/on the frontage requesting patrons to recognise the residential nature of the area and conduct their behaviour accordingly. The management must reserve the right to ask patrons to move inside the premises or leave if it is felt that they could be disturbing neighbours

03/12/2012

**APPENDIX 4 – ENVIROMENTAL HEALTH- TRADING STANDARDS  
REPRESENTATION**

## Anderson Chanel

---

**From:** Tillett Karen  
**Sent:** 03 December 2012 12:22  
**To:** Licensing  
**Subject:** FW: Application for a Premises Licence - BAR ESTEBAN, GROUND FLOOR, 29 PARK ROAD, CROUCH END, LONDON N8 8TE (WK/237580)  
**Attachments:** MEMO- Bar Esteban, 29 Park Road, N8.doc; Application.pdf; Premises Plan.pdf

Trading Standards wish to make the following representation:

The prevention of such activity is not completely addressed in the Licensing Objective concerning the protection of children (Section P(e)).

Measures that we would expect to see in place are:

- A fuller definition of appropriate identification i.e. that such ID must bear a photograph, date of birth and a holographic mark.
- To keep a written record of staff training confirming they have understood the legal requirements

Also recommended is the implementation of a Challenge 25 Policy although this does not form part of the representation.

Kind regards,  
Karen

**Karen Tillett**  
**Joint Trading Standards Manager - Haringey and Waltham Forest**  
**London Borough of Haringey Trading Standards**  
**Lee Valley Technopark,**  
**Ashley Road, Tottenham**  
**London N17 9LN**  
**Telephone: 020 8489 5885**  
**Alt Telephone: 020 8489 8233**  
**Fax: 020 8489 5554**

---

**From:** Shah Noshaba  
**Sent:** 30 November 2012 14:49  
**To:** Building Control; Enforcement Response; Food Haringey; Pearce Derek; Planning Enforcement; Whitehouse Rebecca; Tillett Karen; Thomas Simon; 'YR\_Licensing@met.pnn.police.uk'; 'Fire'; Morris Marion; Ekemezuma Felicia  
**Cc:** Barrett Daliah; Smith Paul; Anderson Chanel  
**Subject:** RE: Application for a Premises Licence - BAR ESTEBAN, GROUND FLOOR, 29 PARK ROAD, CROUCH END, LONDON N8 8TE (WK/237580)

Dear RA's

Please find attached a new premises licence application for the above premise.

Please note the last day of consultation is on 27<sup>th</sup> December 2012.

Could all responses please be forwarded to [licensing@haringey.gov.uk](mailto:licensing@haringey.gov.uk)

**APPENDIX 5 – LETTER OF REPRESENTATION FROM ‘OTHER PARTIES’**

24th December 2012

**Haringey Council  
Licensing Department Team Enforcement  
Service Technopark Ashley Road  
Tottenham  
N17 9LN**

**RE: Bar Estenan 29 Park Road, Ground Floor N8 8TE -Licensing protest**

**Dear Sirs**

**With regards to the above property and its application to obtain a license for a bar till 12 to 12..30am I would strongly like to object. My grounds for this is listed below:-**

- 1. It is a a public nucience to all who live above and near it due to high noise levels which are never turned down and even if they are can still be heard..**
- 2. I live above it and have experience terrible noise pollution from previous bars (i.e. Rhythm bar and bar Twenty Nine) till well past 10pm and on into the small hours of the morning and am unable to sleep.**
- 3. This is totally unacceptable as it is not sound proofed and all and everything can be heard as the walls are paper thin and there are even cracks through the floor boards into the restaurant below from above.**
- 4. All people on either side of the property and above will have no peace and this is completely unfair as everyone desires peace and quite in their own home and no noise pollution from others..**
- 5. This type of bar will only attract the worse type of people who will only bring the neighbourhood down. Again a public annoyance to all who live near it.**

**Yours sincerely**



**Ms Bees  
27 Park Road upper floor  
London  
N8 8TE**



**APPENDIX 5A – COPIES OF LETTERS SENT IN RESPONSE TO REPRESENTATION  
BY THE RESIDENT**

# Bar Esteban



29 Park Road, London N8 8TE

January 8, 2013

Ms Bees  
27 Park Road  
London, N8 8TE

Dear Ms Bees

Thank you for your recent letter, which was forwarded by Haringey Council to both myself and my business partner, Stephen Lironi, earlier today.

We were sorry to hear of your distress caused by the owners of the previous bars, Rhythm and Bar 29 and wanted to write to you personally about our plans for the space.

Although the name of our restaurant does suggest a bar, we will actually be opening a Spanish tapas restaurant. We do not expect to attract a late night bar crowd, nor will we market the new business as such. We have spent the last two years researching high quality Spanish products and ingredients and special regional tapas dishes which we hope the Crouch End community will enjoy. In addition, our wine list will be specializing in Spanish wines and sherries.

In terms of noise, we are sympathetic to all of our neighbors and understand that this has been an issue in the past. We do not intend for our restaurant to have blaring music - in fact we believe that music should never drown out normal levels of conversation. In addition, we can guarantee that no speakers will be placed on the adjacent wall to your property and we do not intend to install a large music system and large speakers.

As long term residents of Crouch End, the last thing we want to do is to "attract the worse type of people" as you mention in point 5 of your letter. We hope that the restaurant will be frequented by locals who are attracted by the menu and in time hope to be as highly thought of in the neighborhood as Banners.

In light of this new information, we would greatly appreciate it, if you would consider withdrawing your letter to the council.

Finally, although not addressed in your letter of December 24<sup>th</sup>, we would like to thank you for your patience regarding any noise that may have been caused by our builders this week. This is, of course, a temporary issue and the bulk of this work should be completed in the next several days.

Should you wish to talk about any of your concerns personally, both Stephen and myself would be very happy to do so. My email is [lisa@baresteban.com](mailto:lisa@baresteban.com), please do not hesitate to contact me directly.

Your sincerely,

Lisa Woolley

Co-Owner/Director

Bar Esteban Ltd



ND/EK/L0151/1

Daliah Barrett  
Haringey Council  
The Licensing Team  
Unit 271 Lee Valley Technopark  
Ashley Road  
London  
N17 9LN

08 January 2013

Dear Ms Barrett

**Re: Application for New Licence  
Bar Esteban  
Ground Floor 29 Park Road London N8 8TE**

Thank you for your email of 8<sup>th</sup> January 2013 and for forwarding to me the letter of representation from Ms Bees.

As you are aware the premises is to run as a family restaurant and not as a music venue. You will also be aware that the live music option was on the previous premises licence which as you are aware expired due to liquidation of the previous tenant company. Our client is very happy to meet with Ms Bees to reassure her that the premises will be run in an orderly fashion as a family restaurant and the only music will be very low volume background music as in any other restaurant. In addition to this our client is quite happy to remove the application for live music on the licence as a special concession to Ms Bees in this matter.

Accordingly we should be grateful if you would convey this to Ms Bees and reassure her that the intention is to run the premises as a high end family restaurant with respectable clientele.

I look forward to hearing from you.  
Yours sincerely

Nick Demos  
**P. George & Co**